

[www.pauldekort.nl](http://www.pauldekort.nl) [info@pauldekort.nl](mailto:info@pauldekort.nl)

©2011

LANDART IN THE OOIJPOLDER

# OPEN

POLDER  
LANDSCAPE  
LANDBORDER

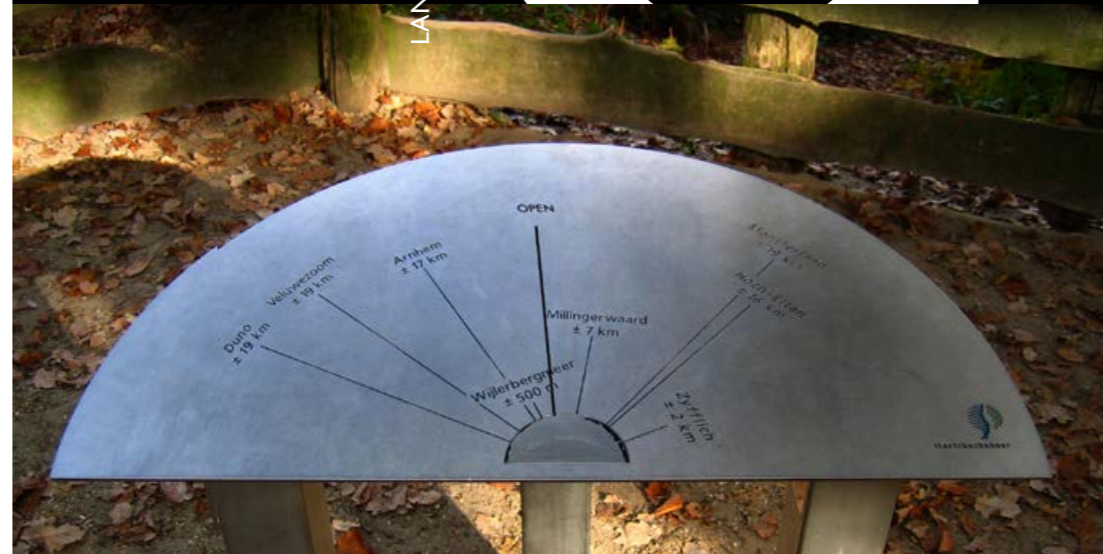

PAUL DE KORT

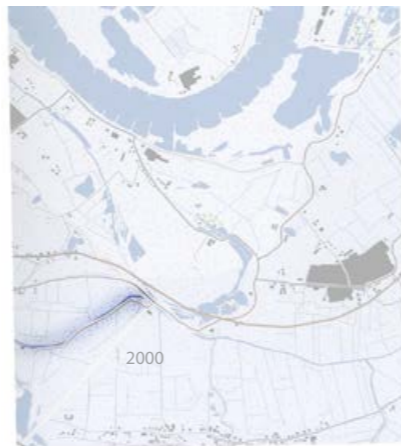

The location for the project is a place that has been 'under pressure' for centuries; stuck between high and low, between a geologically formed push moraine and the river Waal, one of the most important waterway thoroughfares in Europe.

The Roman Limes was situated alongside this place and that was no coincidence.

In Querdamm, water management and territorial drift come together in a sharp line.

LIMES



## LAND ART IN THE OOIJPOLDER

In 2004, a regional landscape development plan was drafted by the municipals Groesbeek, Millingen aan de Rijn and Ubbergen. Central to this development plan for the Ooijpolder are cultural identity, involvement from the residents, ecology, recreation, and the cultural-historical landscape.

In this framework, the county Gelderland drafted an art assignment in 2005. The art assignment requires a piece of land art that responds well to the specific character of Ooijpolder. The county wants a project that is made 'in and with' the landscape and can be managed by local farmers in the name of the so-called green- and blue services.

GENIUS LOCI  
GEOLOGIE / GEOGRAPHY  
PAST / TODAY / FUTURE  
NATURE / CULTURE  
RECREATION / GREEN SERVICES



In the plot that is stuck between the river Het Meer, a bicycle path, and the Querdamm these elements bump into each other. Here, geographic and cultural-historical entwined lines are made visible in a beautiful way. The Querdamm runs in a straight line from the foot of the Duivelsberg to the Kapitteldijk. South-west, the blue-grey shadow of the push moraine and the Duivelsberg function as a backdrop behind a vast scenic landscape. Towards the north-east, traffic rushes over the Kapitteldijk to Germany.



Location for land art



Various viewpoints of the former situation



Overview from the Duivelsberg





Design and feel of the work of art are inspired by the civil engineering works of Defense and Water boards. These buildings form their own typology in our landscape, which could be considered typical for our (river)landscape.

The land art-ish elements constructed by the water boards and the army in our river landscape are partly what makes it so beautiful and of great cultural-historical value.

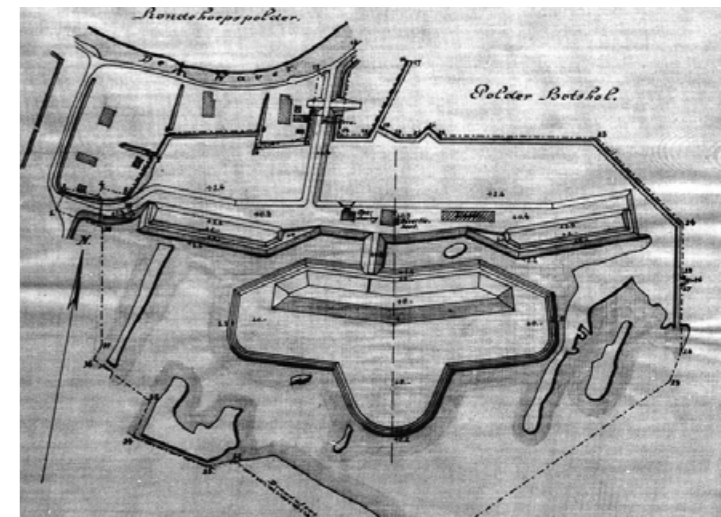

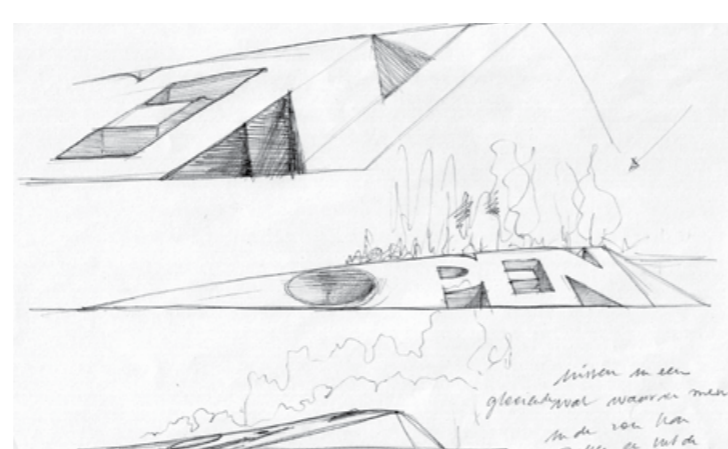
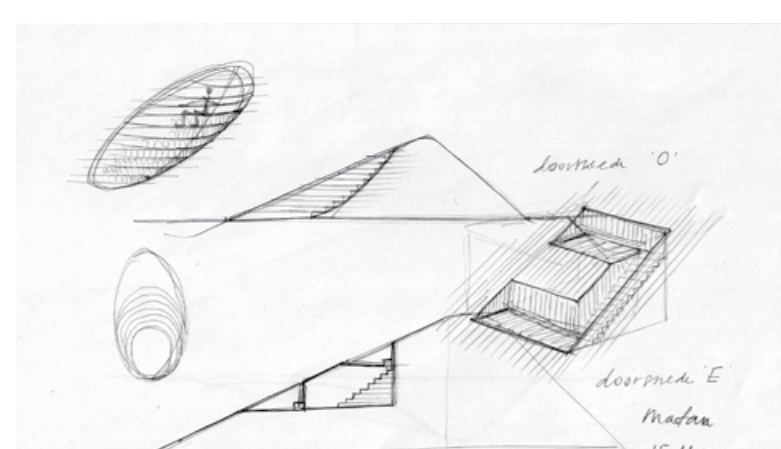

Studies and sketches for OPEN

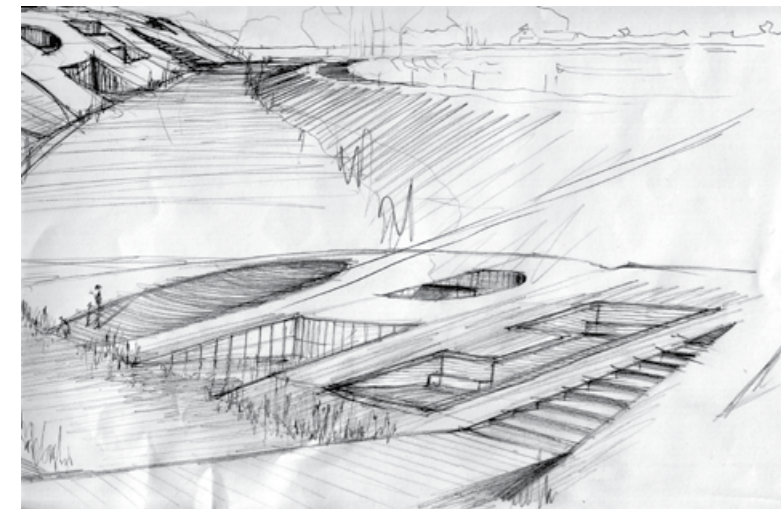

Het Meer is broadened in this area which causes the water to be more visible from the cycling path. Within a closed ground assessment, an island is raised in this broadening, completely surrounded by the water from Het Meer.

It will be an island with alcoves and denominations that form a typographical image, a 'word-image' with an OPEN meaning.

The term OPEN gives a positive spin on every term that is placed behind it; 'open' landscape, 'open' border, 'open' gesture...

The island looks like a fort or stronghold in a defence system, at the same time we are invited in by 'OPEN'.



Model for OPEN



The upkeep and management of the project forms an intrinsic part of the image. Because of varying mowing management the work will look different all the time, at the same time it will enhance the 'readability'.



Gendt

rivier de Waal

OPEN

Kapitteldijk

Pannerden

Millingen

Nederland

Querdamm

Duitsland

Kapitteldijk

Overview from the Duivelsberg over the Ooijpolder





View from the Kapitteldijk





View from the cycling path

The passer-by can curl up in the alcoves and enjoy the sun and view of the Ooijpolder with the push moraine in the background.



